

L-Hygiene™



Hydrogen Peroxide 3% Wipes

Silver Accelerated Hydrogen Peroxide

SPECIFICALLY DESIGNED FOR CLEANING:



Loba Chemie Pvt. Ltd.

Add: Jehangir Villa, 107, Wodehouse Rd.,
Colaba, Mumbai-400005

Web: www.l-hygiene.com
Email: info@l-hygiene.com



EXTREMELY CONVENIENT, SINGLE TIME USE ONLY

IDEAL FOR DISINFECTING SURFACES

Home, Food service areas, Day care centers, Schools, Health care facilities, Universities and research laboratories, Wipe downs on filling and packing machinery, Restaurants and more.

HARD SURFACE COMPATIBILITY

Baked enamel, Glass, Glazed ceramic, Glazed porcelain, Glazed tile, Laminated surfaces, Stainless Steel, Painted surfaces, Plastic, Polycarbonate, Porcelain enamel

Additional Features:

- Non- woven Polycellulose material Each 6" x 8" (150 mm x 200mm)
300 wipes/roll – MORE WIPES AND LESS WASTAGE
- Effective against common pathogens and more.
- No-Toxic Fumes.
- Strongest disinfecting.
- High Absorbency.
- Plastic-safe.



High
Strength



Excellent Solution
Retention



Very Low Linting



Efficient Solution
Release

Typical Product Data and Physical Properties:

Physical State: Wet Wipes
Odor: Fragrant

Non- Volatile, Non- flammable
Shelf life: 1 years

Appearance: White Wipes

No residue formation after wiping the surface

How To Use Hydrogen Peroxide 3% Wipes

STEP 1

Risk Assessment



Please follow your agreed risk assessment policy guidelines regarding the use of PPE.

STEP 2

Wipe Selection

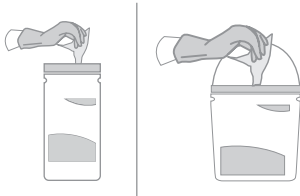

Choose the dispenser type and dispense the wipe.

STEP 3

Fresh Wipe

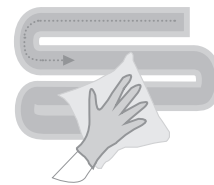

Wipe the surface in an S Shape moving from clean to dirty. Use the wipe flat not scrunched. Do not go over the same area twice with the same wipe.

STEP 4

Fresh Wipe

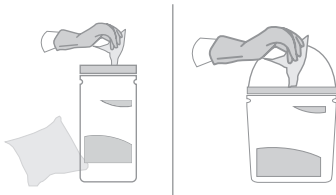

Use a fresh wipe if your wipe becomes soiled or dry.

STEP 5

Discard



Discard used wipes in the appropriate waste bin following your local agreed guidelines.

STEP 6

Let Dry



Allow the surface to dry before use.

Typical Application

BEST PLACES TO USE HYDROGEN PEROXIDE 3% WIPES

- Home
- Food Service Areas
- Day Care Centers
- Schools
- Health care facilities
- Universities and Research laboratories
- Wipe downs on filling and packing machinery
- Restaurants



Available Packing



Code: WHPNF00060
60 Rolled Wet Wipes
6" x 8" Each



Code: WHPNF00300
300 Rolled Wet Wipes
6" x 8" Each



Code: WHPNF00500
500 Rolled Wet Wipes
170 mm x 180 mm Each

